



Model ECP1 Grooved Drain Cap

cULus Listed, FM Approved
300 psi (20.7 bar)

ECP1 Grooved Drain Cap Technical Data

Operating Specifications
Maximum Working Pressure:
300 psi (20.7 bar)

Material Specifications
Body: ASTM A536 Grade 65-45-12 Ductile Iron

Design Specifications*
NPT Thread: B1.20.1
BSPT Threads: ISO 7-1
Groove: AWWA-C606

Available Finishes
Housing:
Red powder-coating
Hot dipped galvanized (ASTM A-153)

Listings and Approvals
cULus Listed
FM Approved



*Cap is available with 1-inch (25 mm) NPT or BSPT threads.

ECP1 Grooved Drain Cap Dimensions

Figure 1

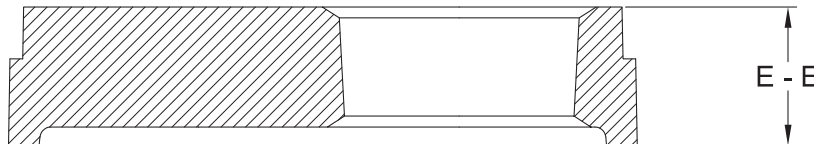

Table A

Grooved x Threaded Nominal Size in (mm)	Pipe O.D. in (mm)	Dimension E - E in (mm)	Weight lb (kg)
2 x 1 (50 x 25)	2.375 x 1.315 (60.3 x 33.7)	15/16 (24)	0.68 (0.31)
2-1/2 x 1 (65 x 25)	2.875 x 1.315 (73.0 x 33.7)	15/16 (24)	0.84 (0.38)
76 mm x 1 (76 x 25)	3.000 x 1.315 (76.1 x 33.7)	15/16 (24)	0.93 (0.42)
3 x 1 (80 x 25)	3.500 x 1.315 (88.9 x 33.7)	15/16 (24)	1.28 (0.58)
4 x 1 (100 x 25)	4.500 x 1.315 (114.3 x 33.7)	1 (25)	1.87 (0.85)
165 mm x 1 (165 x 25)	6.500 x 1.315 (165.1 x 33.7)	1 (25)	4.19 (1.90)
6 x 1 (150 x 25)	6.625 x 1.315 (168.3 x 33.7)	1 (25)	4.19 (1.90)