



Model TE1 Grooved Tee Standard Radius

cULus Listed, FM Approved
300 psi (20.7 bar)

TE1 Grooved Tee Standard Radius Technical Data

Operating Specifications
Maximum Working Pressure:
300 psi (20.7 bar)

Material Specifications
Body: ASTM A536 Grade 65-45-12 Ductile Iron

Design Specification
Groove: AWWA-C606

Available Finishes
Housing:
Red powder coating
Hot dipped galvanized (ASTM A-153)

Listings and Approvals
cULus Listed
FM Approved



TE1 Grooved Tee Standard Radius Dimensions

Figure 1

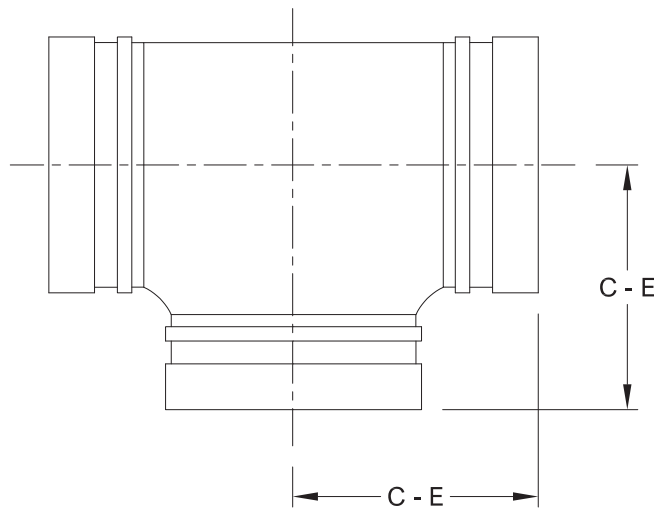

Table A

Nominal Size in (mm)	Pipe O.D. in (mm)	Dimension C - E in (mm)	Weight lb (kg)
1 (25)	1.315 (33.7)	2-1/4 (57)	0.93 (0.42)
1-1/4 (32)	1.660 (42.2)	2-3/4 (70)	1.32 (0.60)
1-1/2 (40)	1.900 (48.3)	2-3/4 (70)	1.65 (0.75)
2 (50)	2.375 (60.3)	3-5/16 (84)	2.62 (1.19)
2-1/2 (65)	2.875 (73.0)	3-3/4 (95)	3.66 (1.66)
76 mm	3.000 (76.1)	3-3/4 (95)	3.66 (1.66)
3 (80)	3.500 (88.9)	4-1/4 (108)	5.18 (2.35)
4 (100)	4.500 (114.3)	5 (127)	8.05 (3.65)
139 mm	5.500 (139.7)	5-1/2 (140)	12.1 (5.5)
165 mm	6.500 (165.1)	6-1/2 (165)	19.40 (8.80)
6 (150)	6.625 (168.3)	6-1/2 (165)	19.40 (8.80)
8 (200)	8.625 (219.1)	7-3/4 (197)	30.30 (13.74)