



Model RGD2 Tongue & Grooved Coupling Rigid Grooved Coupling

cULus Listed, FM Approved
300 psi (20.7 bar)

RDG2 Tongue & Grooved Coupling Technical Data

Operating Specifications

Maximum Working Pressure:
300 psi (20.7 bar)

Operating Temperature:
-30 °F to 230 °F (-34 °C to 110 °C)

Material Specifications

Housings: ASTM A536 Grade 65-45-12 Ductile Iron

Gasket: Pre-lubricated Grade E EPDM

Design Specification

Groove: AWWA-C606

Bolt Specification

SAE J429 Grade 5

Gasket Options

Standard
Flush Gap

Available Finishes

Housing:
Standard red paint
Hot dipped galvanized (ASTM A-153)

Bolts:
Zinc Electroplating

Listings and Approvals

cULus Listed
FM Approved



RDG2 Coupling Dimensions

Figure 1

Gasket Options

Figure 2

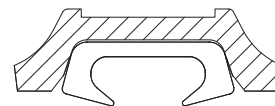
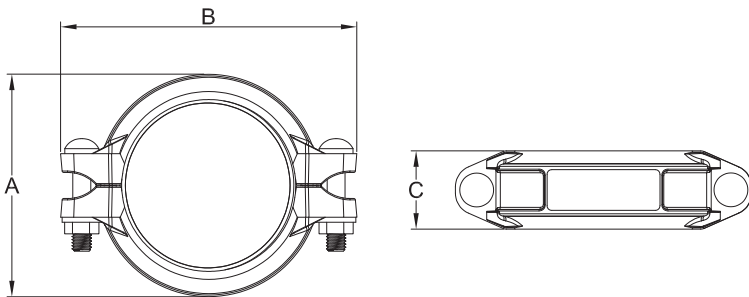

Standard

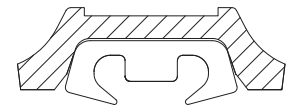

Flush Gap

Table A

Nominal Size in (mm)	Pipe O.D. in (mm)	Max. End Load Lbs (KN)	Pipe End Gap in (mm)	Bolts Size x Length in (mm)	Dimensions			Weight lb (kg)
					A in (mm)	B in (mm)	C in (mm)	
1 (25)	1.315(33.7)	405 (1.8)	1/16 (1.6)	3/8 x 1-1/2 (M10 x 40)	2-3/16 (97)	3-13/16 (97)	1-3/4 (45)	1.06 (0.48)
1-1/4 (32)	1.660(42.4)	656 (2.92)	1/16 (1.6)	3/8 x 1-3/4 (M10 x 45)	2-1/2 (63.5)	4-1/4 (107.5)	1-3/4 (45)	1.17 (0.53)
1-1/2 (40)	1.900 (48.3)	852 (3.79)	1/16 (1.6)	3/8 x 1-3/4 (M10 x 45)	2-3/4 (69)	4-1/2 (114)	1-3/4 (45)	1.28 (0.58)
2 (50)	2.375 (60.3)	1327 (5.91)	1/16 (1.6)	3/8 x 2-1/8 (M10 x 55)	3-5/16 (83.6)	4-7/8 (124)	1-13/16 (46)	1.54 (0.70)
2-1/2 (65)	2.875(73.0)	1945 (8.66)	1/16 (1.6)	3/8 x 2-1/8 (M10 x 55)	3-7/8 (98)	5-3/8 (137)	1-13/16 (46)	1.76 (0.80)
76 mm	2.996 (76.1)	2114 (9.41)	1/16 (1.6)	3/8 x 2-1/8 (M10 x 55)	3-7/8 (98)	5-1/2 (139)	1-13/16 (46)	1.76 (0.80)
3 (80)	3.500 (88.9)	2885 (12.84)	1/16 (1.6)	3/8 x 2-1/8 (M10 x 55)	4-1/2 (114)	6-1/8 (156)	1-13/16 (46)	2.09 (0.95)
4 (100)	4.500 (114.3)	4769 (21.22)	1/8 (4.1)	1/2 x 2-5/8 (M12 x 65)	5-5/8 (142)	7-7/16 (189)	1-15/16 (50)	3.04 (1.38)
125 mm	5.500 (139.7)	7124 (31.70)	1/8 (4.1)	1/2 x 2-5/8 (M12 x 65)	6-11/16 (170)	8-3/4 (222)	1-15/16 (50)	3.86 (1.75)
165 mm	6.500 (165.1)	9950 (44.27)	1/8 (4.1)	1/2 x 2-5/8 (M12 x 65)	7-3/4 (196)	9-5/8 (244)	1-15/16 (50)	4.63 (2.10)
6 (150)	6.625 (168.3)	10340 (46)	1/8 (4.1)	1/2 x 2-5/8 (M12 x 65)	7-13/16 (198)	9-7/8 (251)	1-15/16 (50)	4.63 (2.10)
8 (200)	8.625 (219.1)	17524 (77.97)	1/8 (4.1)	5/8 x 3-1/8 (M16 x 80)	10-1/16 (256)	12-7/16 (316)	2-3/8 (60)	8.71 (3.95)
10 (250)	10.750 (273.0)	27206 (121.05)	1/8 (4.1)	3/4 x 3-1/2 (M20 x 90)	12-9/16 (319)	15-7/16 (393)	2-1/2 (64)	13.71 (6.22)
12 (300)	12.750 (323.9)	38297 (170.39)	1/8 (4.1)	3/4 x 4-1/3 (M20 x 110)	14-3/4 (374)	17-13/16 (453)	2-9/16 (65)	18.74 (8.50)