

MODEL E/E3 2-1/2" & 3" ALARM CHECK VALVE ASSEMBLY DRAWING

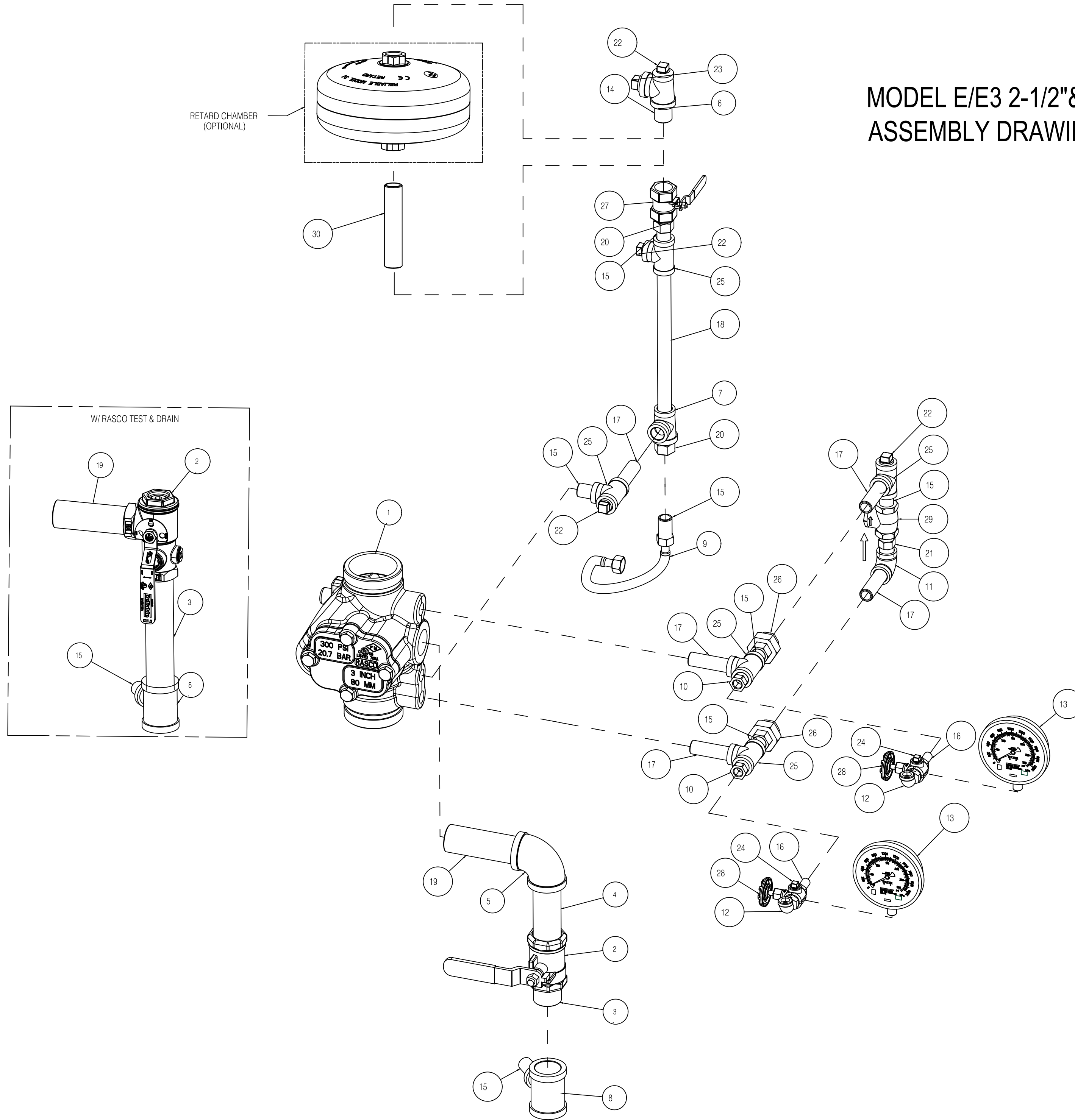

REF.	6303000100	RETARD CHAMBER	OPTIONAL	1
31	95516915	THREAD SEALANT		A/R
30	98543231	NIPPLE, STEEL, GALV., 3/4" X 3"		1
29	98840181	HORIZ. SWING CHECK VALVE, 1/2" NPT		1
28	98840160	VALVE, 3-WAY, 1/4"		2
27	98840108	VALVE, BALL, 3/4" NPT		1
26	98815200	UNION, 1/2, IRON, G.J., GALV.		2
25	98761651	TEE, 1/2X1/2X1/2, GALVANIZED		5
24	98614403	PIPE, PLUG, IRON, SQUARE HEAD, 1/4"		2
23	98614401	PIPE, PLUG, IRON, SQUARE HEAD, 3/4"		1
22	98604406	PIPE, PLUG, IRON, SQUARE HEAD, 1/2"		4
21	98580014	ORIFICE, RESTRICTING, 0.406 DIAMETER., 1/2 NPT, BRASS		1
20	98580002	ORIFICE, DRAIN		2
19	98543284	NIPPLE, 1-1/4X5, GALVANIZED STEEL		1
18	98543252	NIPPLE, 1/2X10-1/2, GALVANIZED STEEL		1
17	98543230	NIPPLE, 1/2X3, GALVANIZED STEEL		5
16	98543226	NIPPLE, 1/4X1-1/2, GALVANIZED STEEL		2
15	98543223	NIPPLE, 1/2X1-1/2, GALVANIZED STEEL		7
14	98543215	NIPPLE, 3/4X1-1/2, GALVANIZED STEEL		1
13	98248001	GAUGE, WATER PRESSURE (0-300 PSI)		2
12	98174408	ELBOW, STREET, 1/4", GALV.		2
11	98174401	ELBOW, 1/2", MALL IRON, GALV.		1
10	98048000	BUSHING, REDUCER, 1/2X1/4, GALVANIZED		2
9	96920912	FLEX LINE, 12		1
8	96606629	TEE, 1-1/4X1-1/4X1/2, GALVANIZED		1
7	96606612	TEE, 3/4X1/2X1/2, GALVANIZED		1
6	96606610	TEE, 3/4X1/2X3/4, GALVANIZED		1
5	98174414	ELBOW, 1-1/4", MALL IRON, GALV.	BALL ONLY	1
4	98543271	NIPPLE, STEEL, GALV., 1-1/4" X 4-1/2"	BALL ONLY	
3	98543295	NIPPLE, STEEL, GALV., 1-1/4" X 8"	RASCO ONLY	1
	98543285	NIPPLE, STEEL, GALV., 1-1/4" X CLOSE	BALL ONLY	1
2	98840137	VALVE, BALL, 1-1/4"		1
	7M99003869	VALVE, RASCO TEST & DRAIN, 1-1/4"		1
1	SEE P/N TABLE	ASSEMBLY, VALVE, E/E3		1
ITEM NO.	PART NO.	DESCRIPTION	REMARKS	QTY.
BILL OF MATERIALS				